



CAMBOURNE
SIXTH FORM

Cambourne Sixth Form

Opening September 2024

www.cambournesixthform.org



@SFCambourne

Welcome to CamSF

We are delighted to be recruiting our first Year 12 cohort for our new Sixth Form, opening in September 2024. Serving 16-19 year olds from the local community and beyond, we offer a wide range of high-quality A Level and applied vocational courses. We're keen to recruit ambitious students who will help us to create a friendly, dynamic and aspirational learning community where every individual is valued and respected, student experience and feedback guide all that we do, and strong staff-student relationships are at the heart of success.

Our broad and engaging curriculum gives students the freedom and flexibility to build an individualised study programme that maximises their sixth form experience.



Our curriculum

Subject choices

A Levels

Art and Design
Biology
Cantonese
Business
Chemistry
Computer Science
Design Technology: Product Design
Drama and Theatre Studies
Economics
English Language
English Literature
Environmental Science
French
Geography
German
Government and Politics
History
Maths
Double Maths

Media
Music
Music Technology
Photography
Physical Education
Physics
Psychology
Philosophy
Sociology
Spanish

Applied courses

L3 BTEC Enterprise and Entrepreneurship (Business)
L3 BTEC Sport

Additional Courses

Cambridge IPQ
Extended Project (EPQ)
Core Maths
L2 Maths and English (resit)

Our broad offer of A Levels and applied courses enables each sixth former to create a personalised programme of study that suits their skills and abilities and sets them on a pathway to their desired future.

The additional courses we offer provide further opportunities for challenge.

In line with all CAM Academy Trust sixth forms, we offer the opportunity to study four A Levels, either as part of a long-term plan or to help inform decision-making about the most appropriate courses.

Entry requirements

A Levels	Applied courses	IPQ
<p>To study A Levels, we require a minimum of five Grade 5s at GCSE, with Grade 4 or higher in English and Maths.</p> <p>Many subjects also have an additional entry requirement, such as a Grade 6 or higher in a related GCSE subject.</p>	<p>Applied courses require a minimum of five Grade 4s at GCSE, including English and Maths.</p>	<p>A minimum of five Grade 7s at GCSE.</p>

A Levels and Applied qualifications represent a significant level of challenge. It is hugely important to us that all students are given the right guidance to choose a pathway that will challenge them and allow them to be successful.

We will offer a guidance meeting to all applicants who meet our admission criteria.

Our facilities

Our purpose-built Sixth Form Centre shares a site with the Village College, but is a distinctive, separate building with its own entrance from West Cambourne, its own parking and a very different ambience. Our new facilities have been designed to provide a fantastic post-16 experience:

- Purpose built STEM facilities including Computer Lab, five Science labs and bespoke Design Technology suite
- Specialist Art, Photography and Music Technology rooms
- A superbly-stocked sixth form library, staffed by qualified librarian, alongside independent study space
- A lecture hall
- A café and outside courtyard for socialising
- The state-of-the-art performance hall and sports facilities of the mainstream school are available for sixth form use.

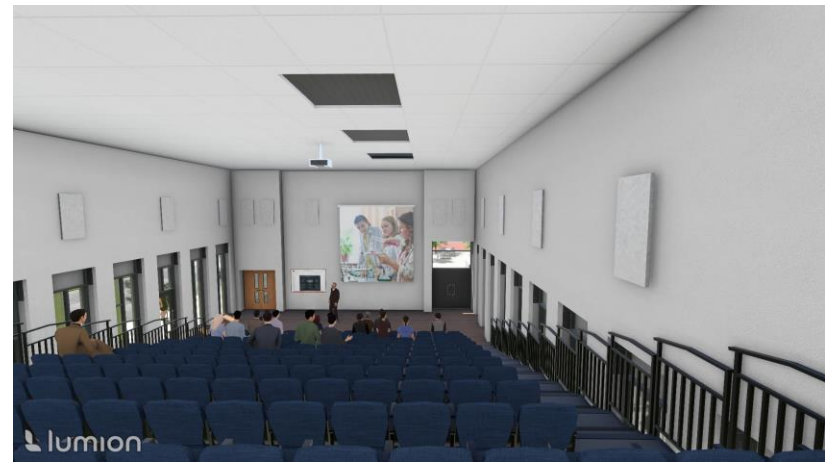

Why study with us?

- 1. Exceptional Pastoral Support:** our personalised programme prioritises student well-being and your form tutor will provide individual support across Years 12 & 13.
- 2. A Diverse and Engaging Curriculum:** with choice from a wide range of subjects, taught by experienced experts in small classes
- 3. Careers and Progression:** Individual guidance is offered throughout your time with us, to encourage and support your highest aspirations.
- 4. Technology:** All sixth form students will have the latest iPad, supplied via an affordable lease-scheme; rapid WiFi and brand-new computer equipment throughout will enhance your educational experience.
- 5. Links with the CAM Academy Trust:** Our close partnership with Comberton Sixth Form, also part of the Cam Academy Trust, allows the sharing of expertise, electives opportunities, international visits and virtual learning events across our centres.
- 6. A Unique Opportunity to Influence:** Our student body will be instrumental in shaping the culture and ethos of our sixth form, creating the traditions of CamSF.

Getting here...

- CamSF and our main site, Cambourne Village College, are easily accessed by bike and on foot from Cambourne. Parking for student bikes and cars is available onsite.
- We are located directly adjacent to the A428, within convenient reach of Cambridge by road.
- The number 4 bus reaches us from Cambridge City Centre in 27 minutes.
- The number 18 bus reaches us from St Neots and villages to the west of Cambourne in just 25 minutes.
- The number 18 bus also reaches us from villages to the east of Cambourne.

More information

www.cambournesixthform.org



@SFCambourne

info@cambournesixthform.org

2023-2024

September

Look out for our Prospectus!

Thursday 2nd November

Join us for our open evening

December

Application made through your school or college

Tuesday 9th January

Deadline for applications

February/March

Admissions guidance meetings for all applicants

April

Conditional offers issues

July

Welcome event and Sixth Form 'Grand Opening'

August

Admissions with your GCSE results

Senior staff will support with any problems.

September

Induction and the beginning of your Post-16 experience